



NON-POWERED[™]

m a t t r e s s s y s t e m

The SW Non-Powered[™] Mattress System offers multiple clinical modalities and options on one base product. Choose to treat patients on the non-powered mode or with a control unit that delivers 1 in 2 alternating air with the reliability of Sizewise Air Systems. This new technology consists of a unique design and materials that deliver optimal comfort and pressure redistribution. The mattress conforms readily to any surface maximizing the patient contact area while reducing skin shear.

SW NP24 MATTRESS[™]

- 3 Unique Zones to Deliver Proper Support & Non-Powered Pressure Redistribution to the Different Body Zones
- 24 Independent Conforming Cells
- Visco Elastic Insert
- Stimulite[®] Heel Insert Available
- Add an Optional Controller for Head-to-Heel Alternation

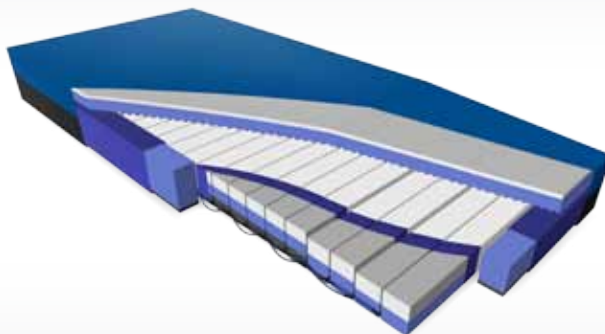

SW NP12 MATTRESS[™]

- 3 Unique Zones to Deliver Proper Support & Non-Powered Pressure Redistribution to the Different Body Zones
- 12 Independent Conforming Cells
- Visco Elastic Insert
- Stimulite[®] Heel Insert Available
- Add an Optional Controller for Head-to-Heel Alternation

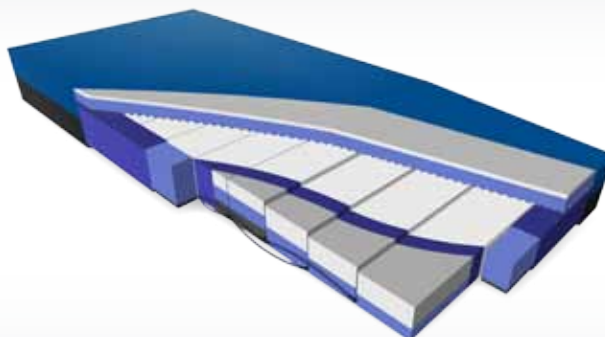

SW NP9 MATTRESS[™]

- 3 Unique Zones to Deliver Proper Support & Non-Powered Pressure Redistribution to the Different Body Zones
- 9 Independent Conforming Cells
- Gradient Heel Slope
- Add an Optional Controller for Head-to-Knee Alternation

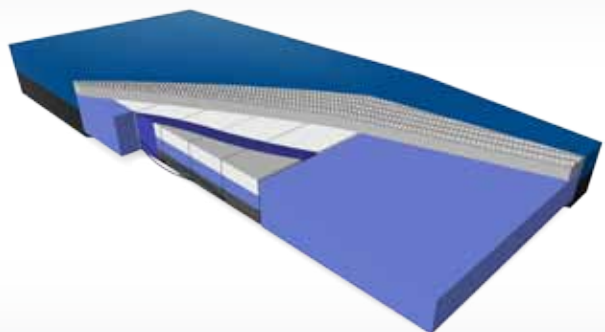

SIZEWISE

800.814.9389 | sizewise.net

SW NP MATTRESSES™

ALL MODELS FEATURE

- Anti-Skid Bottom Cover
- Reinforced Evacuation Handles
- Multi-Zoned Topper
- Fits Any Medical Bed Frame
- Choice of Low Shear Taffeta or 4-Way Stretch Top Cover
- High Density Foam Comfort Layer

STANDARD SIZES AVAILABLE

- 35W x 80L x 7H | 500 lb. Capacity
 - 35W x 84L x 7H | 500 lb. Capacity
 - 35W x 80L x 9H | 500 lb. Capacity
 - 35W x 84L x 9H | 500 lb. Capacity
 - Hill-Rom TotalCare® Replacement
 - Hill-Rom VersaCare® Replacement
- Bariatric & Custom Sizes Available**

OPTIONS AVAILABLE

- Optional Fire Barrier Meets CPSC 1633, BFDIX-11 & TB 129
- Stimulite® Heel Insert for High Risk Patients
- Custom Graphic Printing
- Defined Perimeter with Ingress/Egress

-  Supracor® Stimulite® Heel Insert Available Option Exclusive to Sizewise™

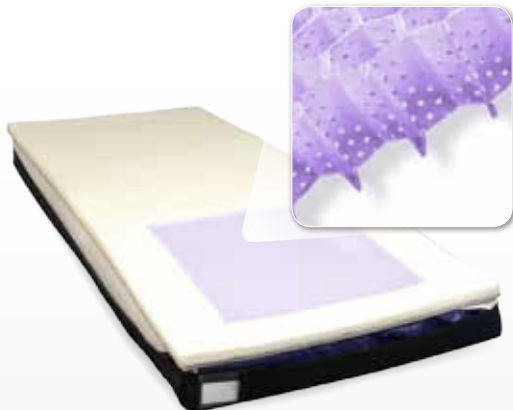

- APM Pump™ – Alternating Air Option

• Top Cover Color Options

4-Way Stretch | Royal Blue

Nylon Taffeta | Purple

Nylon Taffeta | Wine

Nylon Taffeta | Navy Blue